

HOW TO CREATE REALiSTiC FUZZY FELT



FOR PS/PSE USERS

Realistic Fuzzy Felt

Realistic fuzzy felt is a super fun effect you can use in your scrapping to create really cute elements for your pages.

This is a super easy way to achieve the look.

First, open your element or shape, make sure it's highlighted in the layer palette, click on your brush tool and load a felt brush.

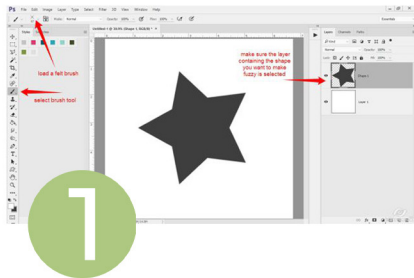

While holding down the control button, click on the element/shape so that the element/shape is selected ("marching ants" appear around the element/shape)

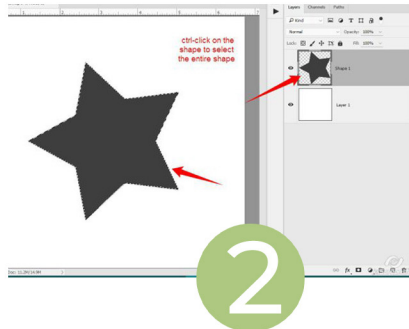

For those of you using PS CS/CC, click on the paths tab.

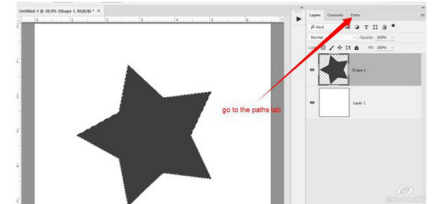

Create a work path by clicking on this icon at the bottom of the paths panel:

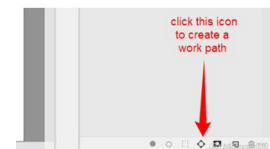

Then click on the open circle icon to apply the brush around the edges of the element/shape:

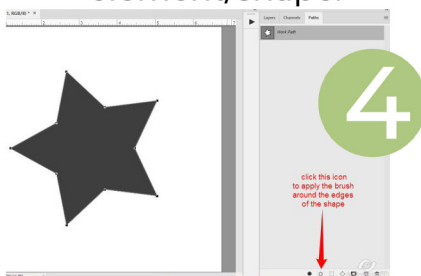

Then click on the trash bin icon to delete the work path:

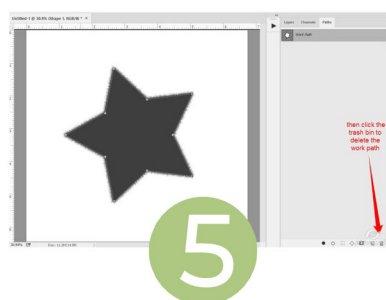

If you are using PSE, which does not have work path capability (that I know of), back to the selection around the element/shape...

Click on Select > Inverse and then you will have to manually "paint" around the edges of your shape with the felt brush:

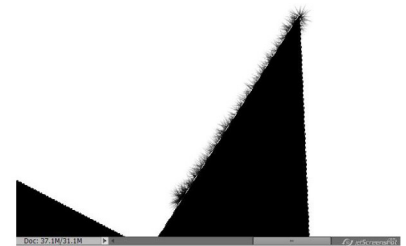

Now you are ready to apply the felt style to the shape:

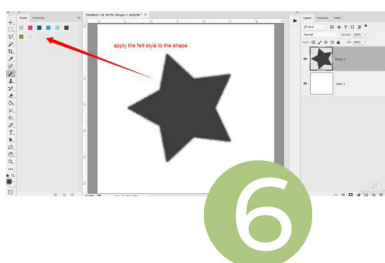

That's all there is to it! Here's a close up view:

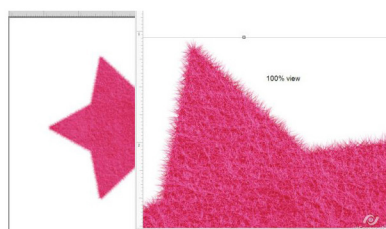

Once you've gotten all the way around your element/shape, deselect by pressing CTRL-D or go to Select > Deselect

PICKLEBERRYPOP

real life • real memories

